

Parts list - Catalog

Cutting and bending automat C068

Table of contents

| | |
|-----------------------------|------|
| chassis | Tz 1 |
| case | Tz 2 |
| drive | Tz 3 |
| drive - curve bearing | Tz 4 |
| drive - lever bearing | Tz 5 |
| bin holder | Tz 6 |
| tool holder | Tz 7 |
| safety hood | Tz 8 |
| magazine | Tz 9 |

Tz 1 - chassis

Rev.-No. 002/ 99 12 01

| Pos. | pieces | drawing No. | Description | Note |
|------|--------|-------------|------------------|-------------------|
| 10 | 1 | Tz 1 T.10 | Plate | |
| 11 | 1 | Tz 1 T.11 | Side plate right | |
| 12 | 1 | Tz 1 T.11 | side plate left | |
| 13 | 1 | Tz 1 T.11 | cover plate | |
| | | | | |
| 15 | 1 | | rubber foot | |
| 16 | 4 | | control device | |
| 17 | 1 | | counter | customer's desire |

Tz 2 - case

Rev.-No. 002/ 99 12 03

| Pos. | pieces | drawing No. | Description | Note |
|------|--------|-------------|---------------------|------|
| 1 | 1 | Tz 2 T.1 | plate | |
| 2 | 1 | Tz 2 T.2 | side plate right | |
| 2a | 1 | Tz 2 T.2a | side plate left | |
| 3 | 1 | Tz 2 T.3 | drawer | |
| 4 | | Tz 2 T.4 | fixing | |
| 5 | 1 | Tz 2 T.5 | cover plate | |
| 6 | 1 | Tz 2 T.6 | plate | |
| 7 | 1 | Tz 2 T.7 | clamp | |
| 8 | 1 | Tz 2 T.8 | bushing bolt | |
| 9 | 3 | Tz 2 T.9 | wave, hardened | |
| 10 | 1 | Tz 2 T.10 | wave, hardened | |
| | | | | |
| 19 | 1 | | grip, 10501-003 154 | |

Tz 3 - drive

Rev.-No. 000/ 96 12 01

| Pos. | pieces | drawing No. | Description | Note |
|------|--------|-------------|--------------------------------|------|
| 1 | 1 | Tz 3 T.1 | toothed wheel | |
| 2 | 1 | Tz 3 T.2 | engine collar | |
| 3 | 4 | Tz 3 T.3 | bolt | |
| 4 | 1 | Tz 3 T.4 | shaft nut | |
| 5 | 1 | Tz 3 T.5 | locking bar | |
| | | | | |
| 6 | 1 | | toothed belt, T5-330 lg. 10 mm | |
| 7 | 1 | | needle bearing, NK 8/16 | |
| 8 | 1 | | engine | |

Tz 4 - drive curve bearing

Rev.-No. 002/ 99 12 03

| Pos. | pieces | drawing No. | Description | Note |
|------|--------|-------------|--------------------------------|------|
| 1 | 1 | Tz 4 T.1 | bearing | |
| 2 | 1 | Tz 4 T.2 | wave | |
| 3 | 1 | Tz 4 T.3 | wave | |
| 4 | 2 | Tz 4 T.4 | disk | |
| 5 | 3 | Tz 4 T.5 | toothed belt wheel | |
| | | | | |
| 7 | 1 | Tz 4 T.7 | curve 1 | |
| 8 | 1 | Tz 4 T.8 | curve 2 | |
| 9 | 1 | Tz 4 T.9 | curve 4 | |
| 10 | 1 | Tz 4 T.10 | curve 3 | |
| 11 | 1 | Tz 4 T.11 | curve 6 | |
| 12 | 1 | Tz 4 T.12 | locking bar | |
| 13 | 1 | Tz 4 T.13 | shaft nut | |
| 14 | 1 | Tz 4 T.14 | toothed belt, T5-330 lg. 10 mm | |
| 15 | 4 | Tz 4 T.15 | grooved ball bearing | |
| | | | | |
| 16 | 1 | | needle bearing, NK 8/16 | |
| 17 | 2 | | fitting key, A6 x 6 x 30 | |
| 18 | 1 | | fitting key, A6 x 6 x 20 | |

Tz 5 - drive lever bearing

Rev.-No. 002/ 97 09 18

| Pos. | pieces | drawing No. | Description | Note |
|------|--------|-------------|--------------------------------|------|
| 1 | 2 | Tz 5 T.1 | clamp | |
| 4 | 2 | Tz 5 T.4 | bolt | |
| 5 | 6 | Tz 5 T.5 | disk | |
| 6 | 1 | Tz 5 T.6 | nut | |
| 7 | 1 | Tz 5 T.7 | lever | |
| 8 | 1 | Tz 5 T.8 | survey | |
| 9 | 1 | Tz 5 T.9 | spring bolt clamp | |
| 10 | 2 | Tz 5 T.10 | spring bolt | |
| 11 | 2 | Tz 7 | Mainspring (Nr. 14776) | |
| 12 | 1 | Tz 5 T.12 | tapped | |
| 13 | 1 | Tz 5 T.13 | fixing | |
| 14 | 1 | Tz 5 T.14 | spring bolt | |
| 15 | 1 | Tz 5 T.15 | spring bolt | |
| 16 | 1 | Tz 5 T.16 | adjustable ring | |
| 17 | 5 | | grooved ball bearing, 624 - 2z | |
| 19 | 4 | Tz 5 T.19 | lever | |
| 20 | 4 | Tz 5 T.20 | lever | |
| 21 | 4 | Tz 5 T.21 | lever | |
| 22 | 2 | Tz 5 T.22 | clamp | |
| 23 | 2 | Tz 5 T.23 | cap | |
| 24 | 4 | | pressure spring, D-166 D | |

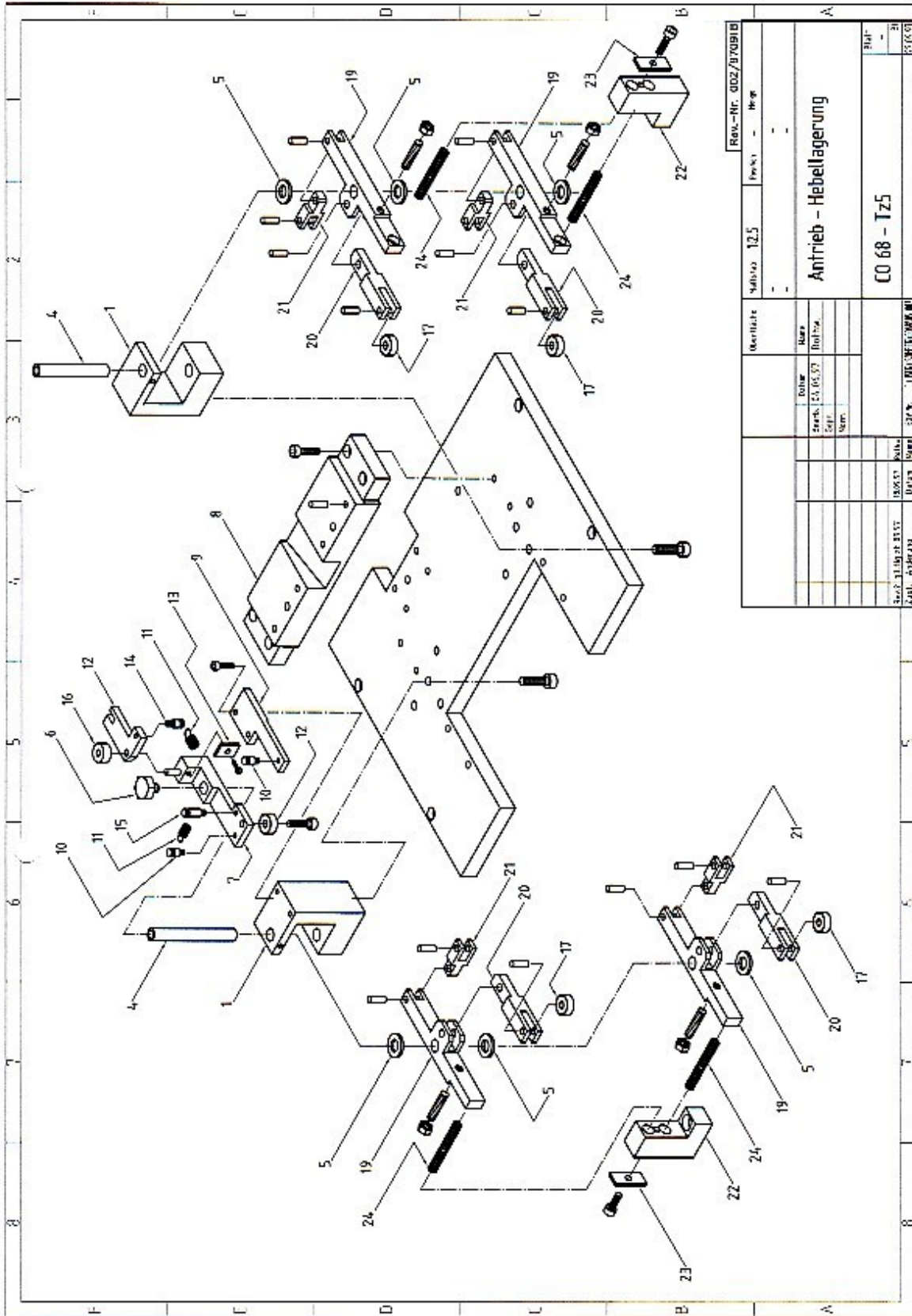

| | | | | | |
|--------------------------------|------------|------------|------------|------------|------------|
| Rev.-Nr. | 002/070918 | Part | - | Page | - |
| Substanz | T2.5 | Übersicht | | | |
| Antrieb - Hebellagerung | | | | | |
| C0 68 - Tz5 | | | | | |
| Zust. Änderung | | Nr. | 01 | 02 | 03 |
| Datei | | 002/070918 | 002/070918 | 002/070918 | 002/070918 |
| Zust. Änderung | | Nr. | 01 | 02 | 03 |
| Datei | | 002/070918 | 002/070918 | 002/070918 | 002/070918 |

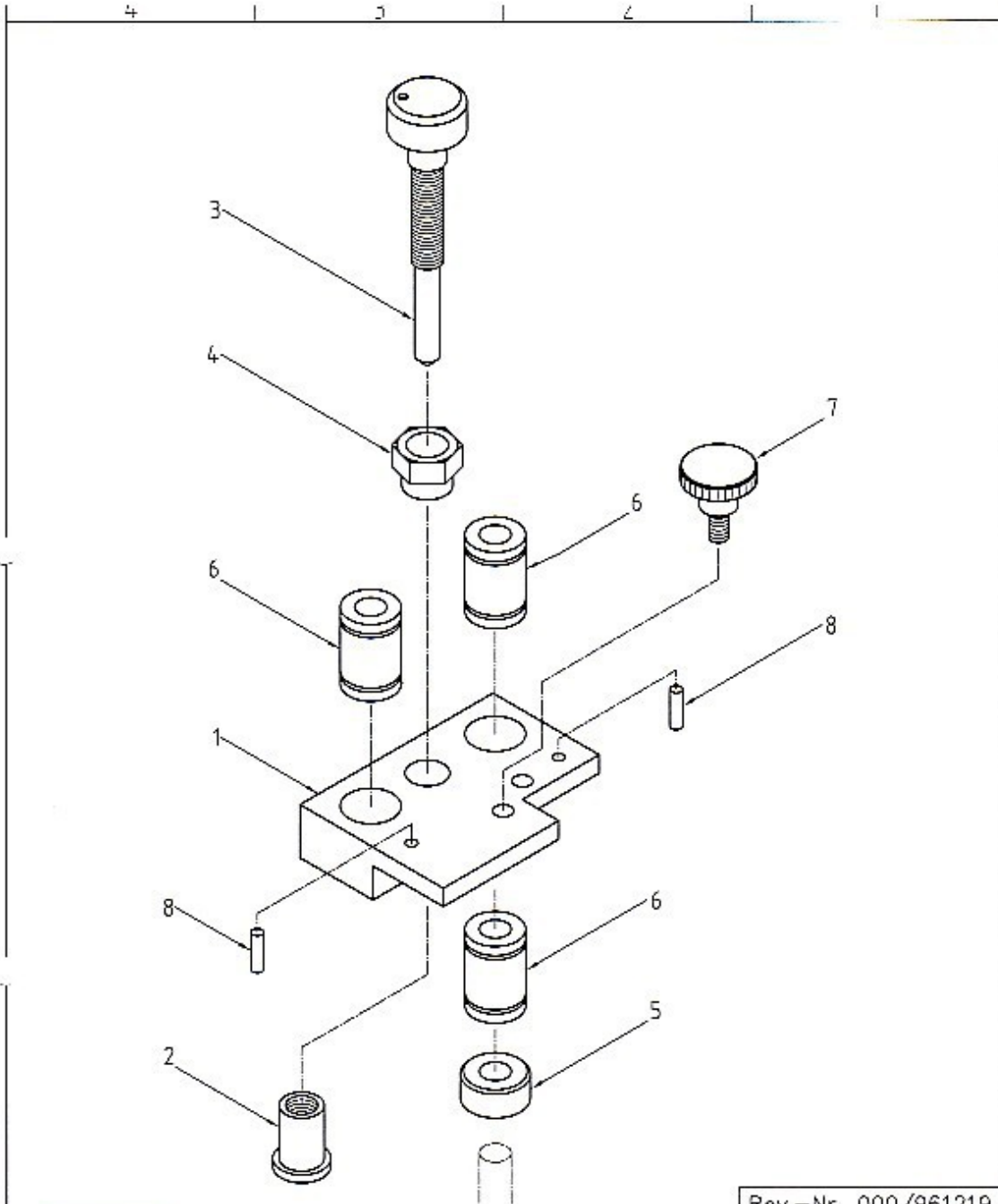

Rev.-Nr. 000/961219

| | | | | | | | | | | |
|--------|-------------|----------|-------|--------------|------------------------------|------------------|------------------|----------|-------|--|
| | | | | Oberfläche | | Maßstab 1:2 | Position - Menge | | | |
| | | | | | | - | - | | | |
| | | | | Datum | Name | Magazin - Träger | | | | |
| | | | | Bearb. | 19.12.96 | | | | Rothw | |
| | | | | Gepr. | | | | | | |
| | | | | Norm | | | | | | |
| | | | | | | | | Blatt | | |
| | | | | | | | | - | | |
| Rev. 0 | ab Prototyp | 19.12.96 | Rothw | CO 68 - Tz 6 | | | | Blatt | | |
| Zust. | Änderung | Datum | Name | EDV-Nr. | C:\SERVIS\METRIC\CO68\GE 000 | | | E! | | |
| | | | | | | | | 29.06.96 | | |

Tz 7 - Tool Support

Rev.-No. 002/ 97 09 18

| Pos. | pieces | drawing No. | Description | Note |
|------|--------|-------------|--------------------------|------|
| 1 | 2 | Tz 7 T.1 | Tool Block | |
| 2 | 2 | Tz 7 T.2 | Cover Plate | |
| | | | | |
| 5 | 1 | Tz 7 T.5 | Spring Angle | |
| | | | | |
| | | | | |
| 8 | 1 | Tz 7 | Mainspring (Nr. 14776) | |
| | | | | |
| 10 | 2 | Tz 7 | Socket screw M5 x 20 | |
| 11 | 8 | Tz 7 | Socket screw M3 x 8 | |
| 12 | 4 | Tz 7 | Countersink screw M3 x 6 | |
| 13 | 1 | Tz 7 | Socket screw M3 x 6 | |
| | | | | |
| | | | | |
| | | | | |
| | | | | |
| | | | | |
| | | | | |

| Pos. | pieces | drawing No. | Description | Note |
|------|--------|-------------|---------------------|------|
| 6 | 1 | Tz 8 T.6 | Cover Plate | |
| 7 | 1 | Tz 8 T.7 | Cover Plate | |
| 8 | 1 | Tz 8 T.8 | Cover Plate | |
| | | | | |
| | | | | |
| | | | | |
| 12 | 1 | Tz 8 T.12 | Acrylic Safety Hood | |
| 13 | 2 | Tz 8 T.13 | Stand Off | |
| 14 | 1 | Tz 8 T.14 | Angle | |
| | | | | |
| | | | | |
| 20 | 1 | Tz 8 | Safety Switch | |
| | | | | |
| | | | | |
| | | | | |
| | | | | |
| | | | | |

| Pos. | pieces | drawing No. | Description | Note |
|------|--------|-------------|---------------------------------|------|
| 1 | 1 | Tz 9 T.1 | Plate | |
| 2 | 1 | Tz 9 T.2 | Block | |
| 3 | 1 | Tz 9 T.3 | Bridge Plate | |
| | | | | |
| 5 | 1 | Tz 9 T.5 | Indexing Arm | |
| | | | | |
| 7 | 1 | Tz 9 T.7 | Retaining Pin | |
| 8 | 1 | Tz 9 T.8 | Stop Plate | |
| 9 | 2 | Tz 9 T.9 | Magazine Cover Plate | |
| 10 | 2 | Tz 9 T.10 | Magazine Cover Plate | |
| 11 | 1 | Tz 9 T.11 | Magazine | |
| 12 | 1 | Tz 9 T.12 | Plate | |
| 13 | 1 | Tz 9 T.13 | Block | |
| 14 | 1 | Tz 9 T.14 | Block | |
| 15 | 1 | Tz 9 T.15 | Strab | |
| 16 | 2 | Tz 9 T.16 | Sleeve | |
| 17 | 2 | Tz 9 T.17 | Disk | |
| 18 | 1 | Tz9 T.18 | Tube Attachment (Input) | |
| | | | | |
| 20 | 1 | Tz 9 T.20 | Stop Plate | |
| 21 | 1 | Tz 9 T.21 | Loose Feed Attachment (Right) | |
| 22 | 1 | Tz 9 T.22 | Cover Plate for Item 21 | |
| 23 | 1 | Tz 9 T.23 | Guide | |
| 24 | 1 | Tz 9 T.24 | Loose Feed Attachment (Left) | |
| 25 | 1 | Tz 9 T.25 | Cover Plate for Item 24 | |
| 26 | 1 | Tz 9 T.26 | Indexing Plate Set | |
| 27 | 2 | Tz 9 T.27 | Spring (D - 063 N) | |
| 28 | 1 | Tz 9 | Spring (D - 029) | |
| 29 | 1 | Tz 9 | Spring Plunger M5 | |
| 30 | 1 | Tz 9 | Hex Nut M5 | |
| 31 | 1 | Tz 9 T.31 | Indexing Block (Left) | |
| 32 | 1 | Tz 9 T.32 | Indexing Block (Right) | |
| | | | | |

